

PROJECT TITLE
**LINCOLN
LOGISTICS
BREWSTER-
BLDG A**

NY-312 & PUGSLEY R
SOUTHEAST, NY 10561

ARCHITECT
ADBI / DESIGN SERVICES LLC
44 SOUTH BROADWAY, SUITE 1003
WHITE PLAINS, NY 10601

CIVIL ENGINEER
LANGAN ENGINEERING
300 KIMBALL DRIVE
PARSIPPANY, NJ 07054

STRUCTURAL ENGINEER
SMITH/ ROBERTS AND ASSOCIATES, INC
6501 BLUFF RD.
INDIANAPOLIS, INDIANA 46217

MECHANICAL ENGINEER
NATIONAL DESIGN/ BUILD SERVICES
11840 BORMAN DRIVE
ST. LOUIS, MO 63146

ELECTRICAL ENGINEER
FXB ENGINEERING
5 CHRISTY DRIVE, SUITE 307
CHADDS FORD, PA 19317

PLUMBING ENGINEER
MCCARTHY ENGINEERING ASSOCIATES,
INC.
315 EAST SECOND STREET
BOYERTOWN, PA 19512

FIRE PROTECTION ENGINEER
S A COMUNALE CO. INC.
2900 NEWPARK DRIVE
BARBERTON, OH 44203

SEAL

JOSEPH V. DIGIORGIO | NY: 042948

SUBMITTALS		
NO.	DATE	DESCRIPTION
0	05.27.2022	PROGRESS SET

PROJECT NO.	DRAWN BY
AS286-21 NY131	ARCO

SHEET TITLE
ROOF DETAILS

SHEET NO. _____

A-8.32

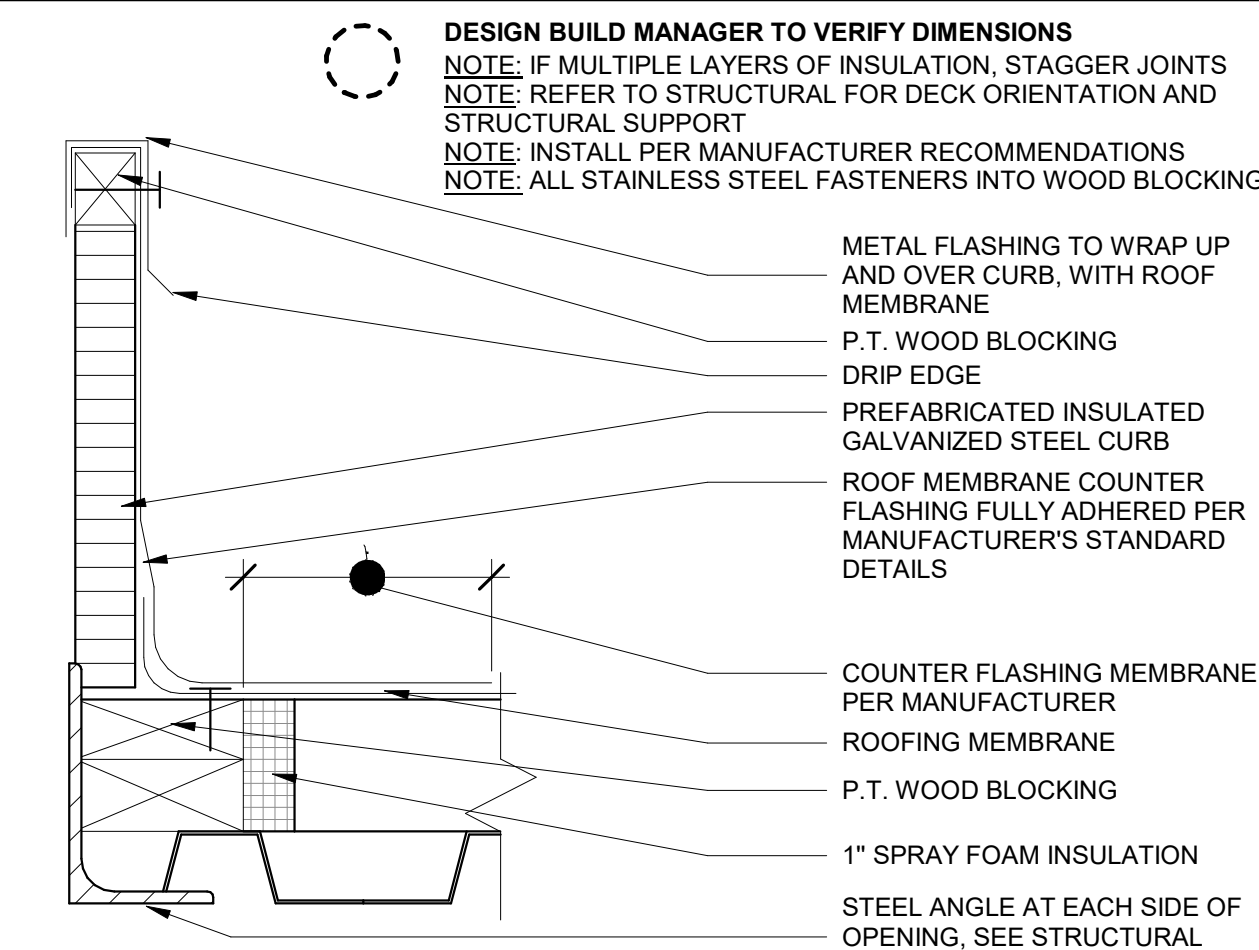

MECHANICAL CURB

A3.17 | REVISION DATE: 11.12.2018 | SCALE: 3" = 1'-0"

1

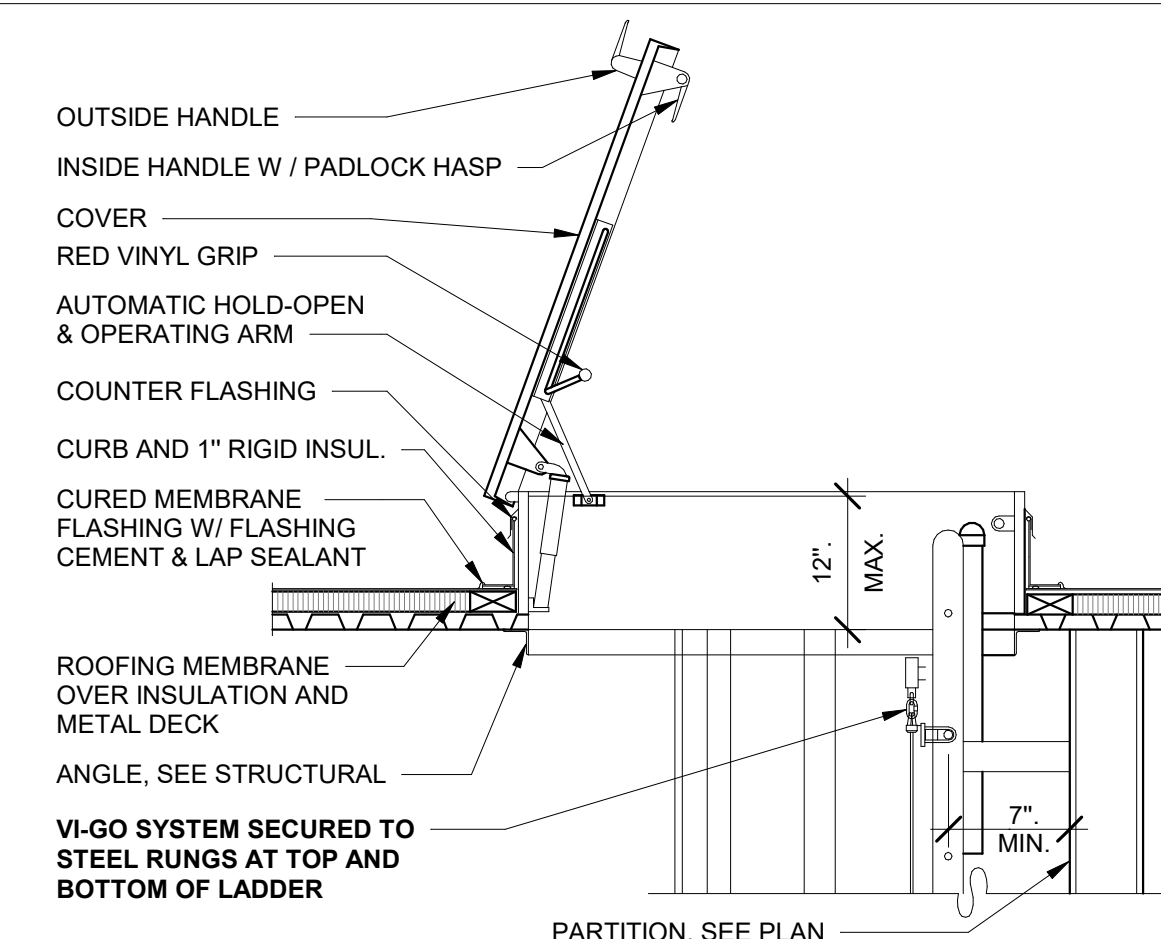

ROOF SCUTTLE

A10.4 | REVISION DATE: 04.23.2019 | SCALE: 1/2" = 1'-0"

2

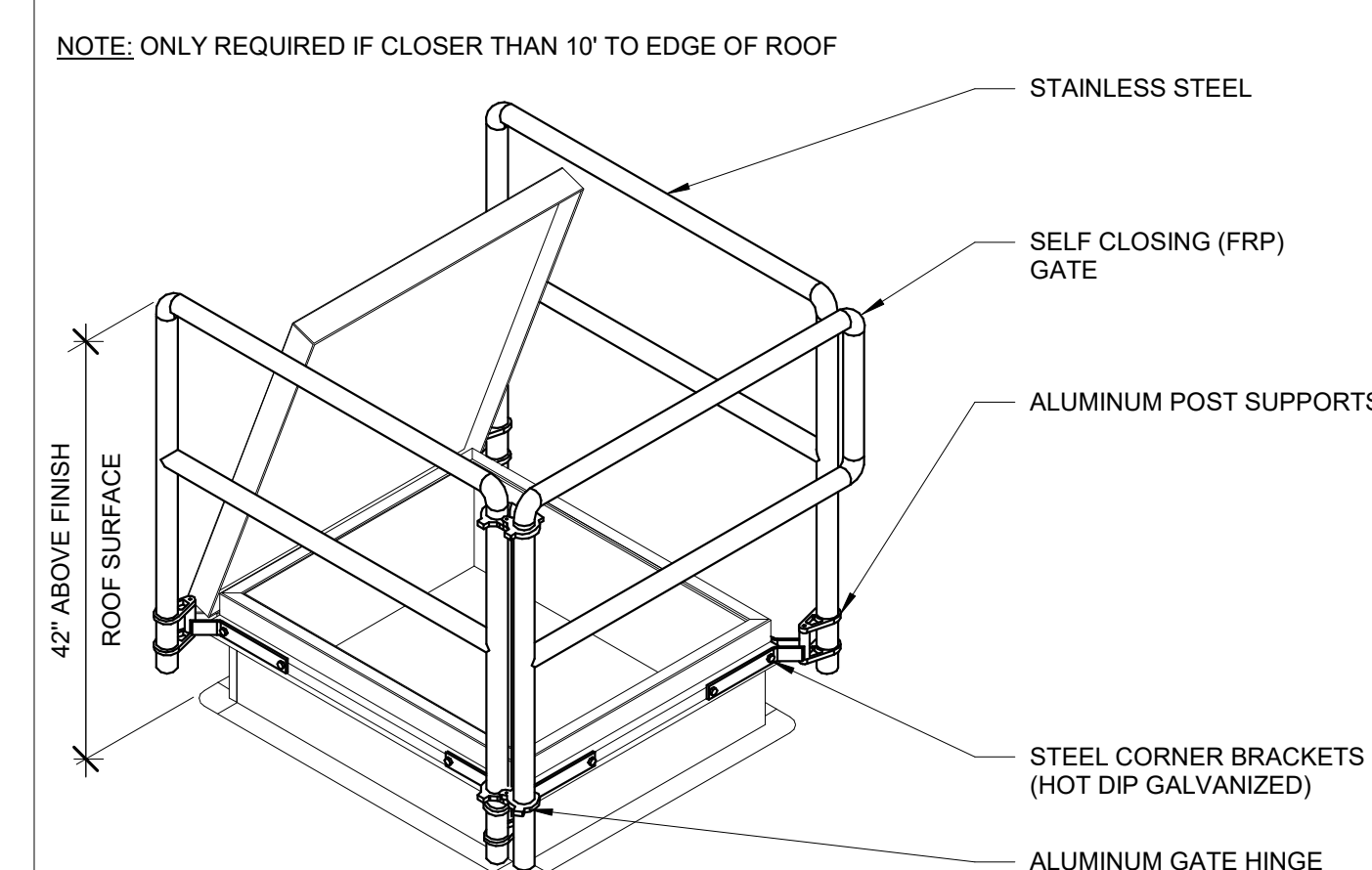

ROOF HATCH RAILING

A10.3 | REVISION DATE: 11.12.2018 | SCALE: 1 1/2" = 1'-0"

3

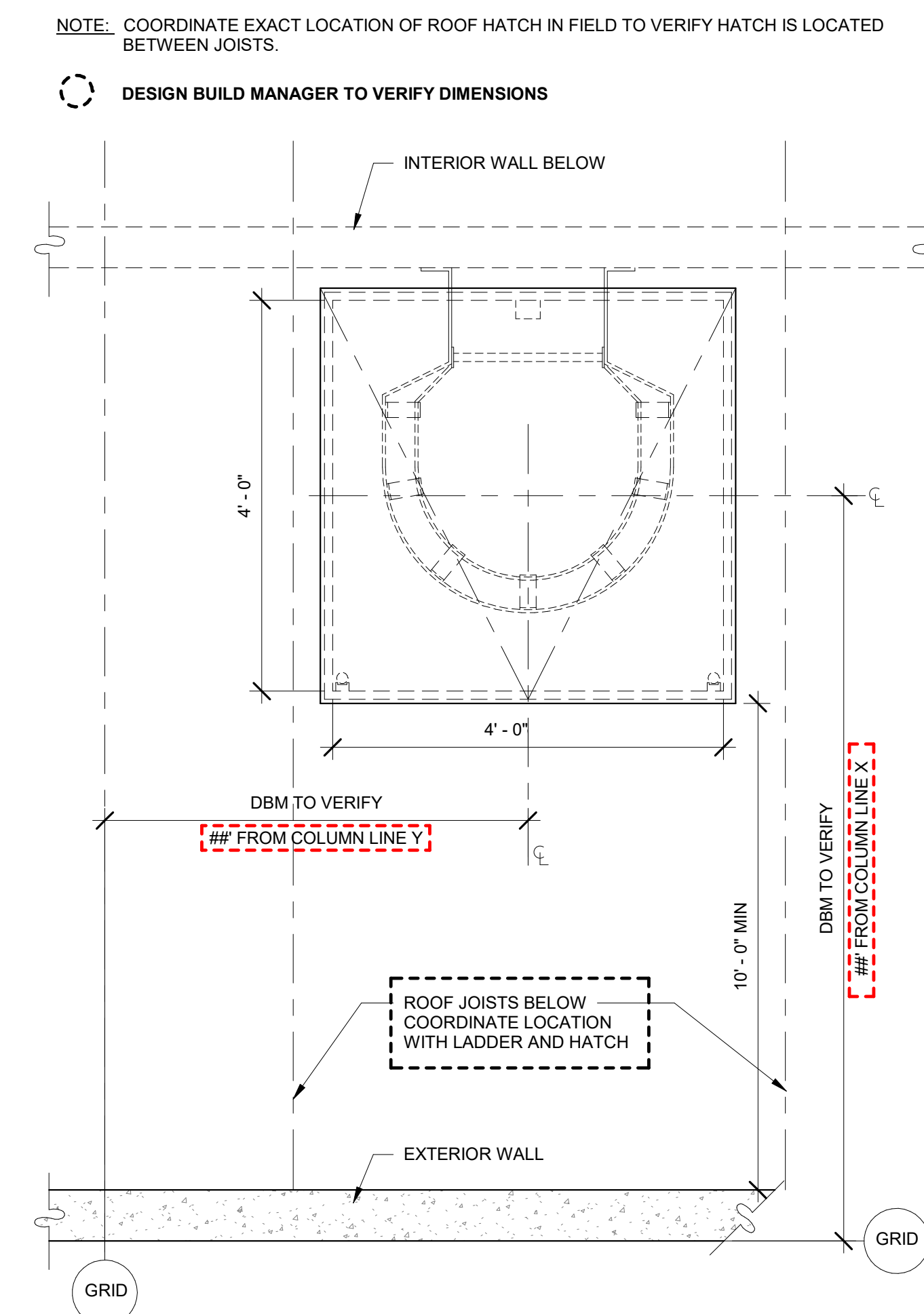

ROOF HATCH

A10.2 | REVISION DATE: 11.12.2018 | SCALE: 3/4" = 1'-0"

9

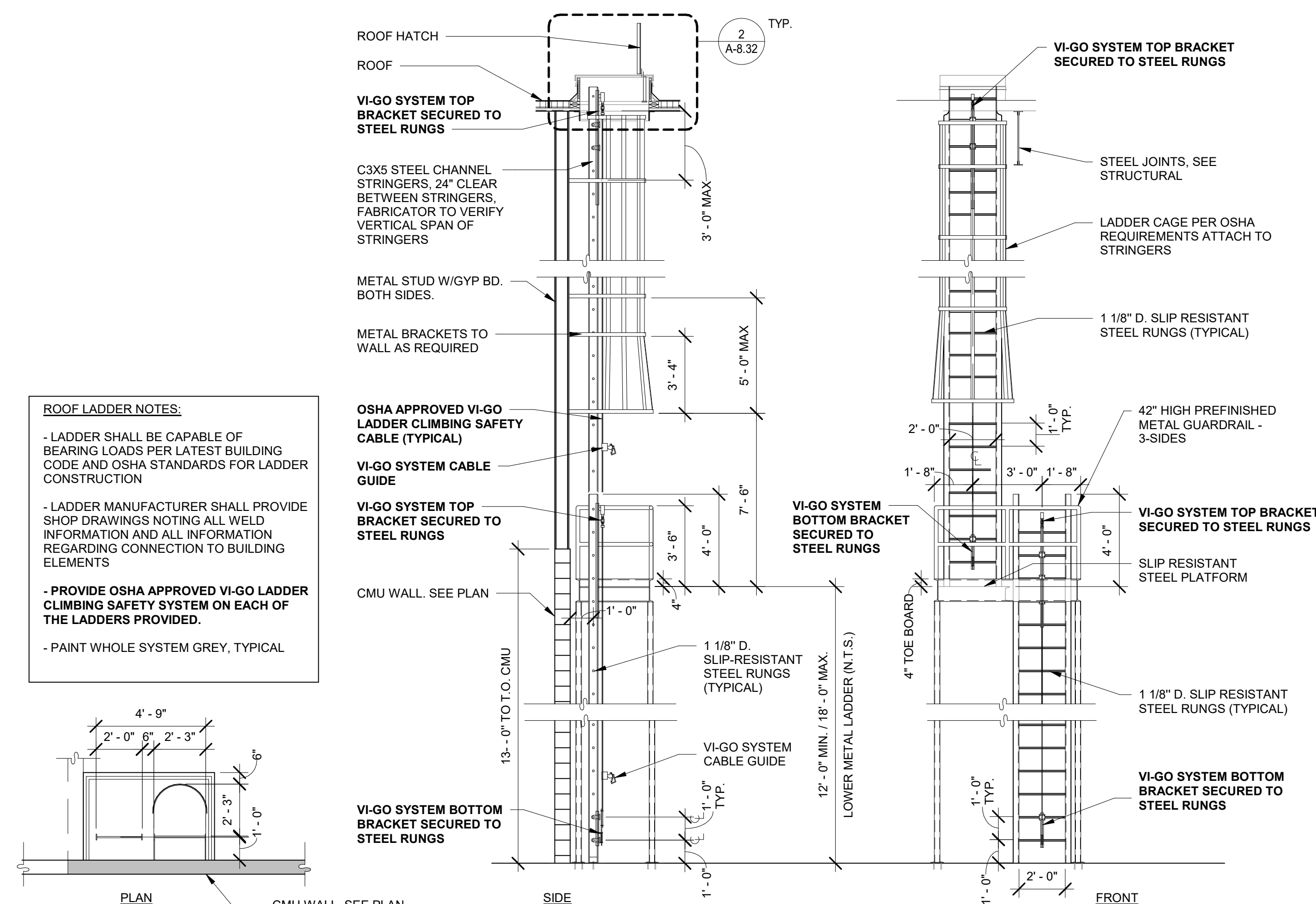

ROOF LADDER W/ CAGE & PLATFORM

A10.1 | REVISION DATE: 11.12.2018 | SCALE: 1/4" = 1'-0"

A